

Waveguide Twist

WAVEGUIDE TWISTS

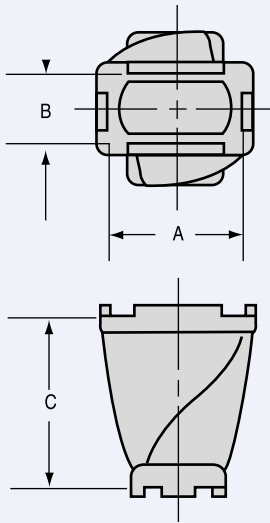

MDL compliments its broad line of cast components with a new high performance cast twist. A full 90° right hand waveguide twist is provided in a minimal length (approximately 3/4 of wavelength at mid-band). A graded effect in the broadwall design produces very low reflections. VSWR is 1.05 max for casting, and 1.10 for twists and flanges. Power handling capacity is approximately 90% of standard waveguide rating.

W/G Size	Freq. GHz	Model Number	A	Dimensions B	C
WR22	33.0-50.0	22TW12	.306	.194	.292
WR28	26.5-40.0	28TW12	.362	.222	.408
WR34	22.0-33.0	34TW12	.422	.252	.500
WR42	18.00-26.50	42TW12	.502	.252	.625
WR51	15.00-22.00	51TW12	.592	.337	.750
WR62	12.40-18.00	62TW12	.704	.393	.880
WR75	10.00-15.00	75TW12	.852	.477	1.000
WR90	8.20-12.40	90TW12	1.002	.502	1.250
WR102	7.00-11.00	102TW12	1.150	.640	1.375
WR112	7.05-10.00	112TW12	1.252	.627	1.437
WR137	5.85-8.20	137TW12	1.503	.753	1.750
WR187	3.95-5.85	187TW12	2.004	1.004	2.500
WR284	2.60-3.95	284TW12	3.004	1.504	4.000

TWISTS WITH FLANGES

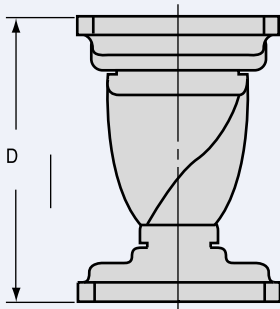

Twist with Flanges

W/G Size	Freq GHz	Model Number	Dimensions (D)
WR42	18.00-26.50	42TW18	1.30
WR51	15.00-22.00	51TW18	1.52
WR62	12.40-18.00	62TW18	1.75
WR75	10.00-15.00	75TW18	2.10
WR90	8.20-12.40	90TW18	2.30
WR102	7.00-11.00	102TW18	2.60
WR112	7.05-10.00	112TW18	2.90
WR137	5.85-8.20	137TW18	3.50
WR187	3.95-5.85	187TW18	4.60
WR284	2.60-3.95	284TW18	7.50