

Pads

Pad Element

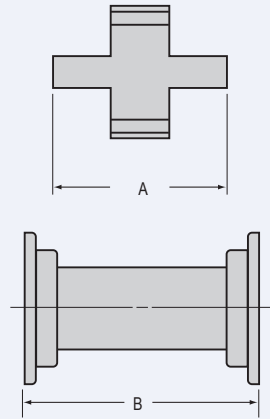

W/G SIZE	FREQ. RANGE (GHz)	MDL MODEL NUMBER	ATTENUATION dB (NOMINAL)	SENSITIVITY dB (MAX.)	VSWR (MAX.)	PAD ELEMENT A (MAX.)
WR28	31.0-37.0	28AF12	10±1	±0.50	1.20	0.50
	31.0-37.0	28AF22	20±1	±1.00	1.25	0.90
	31.0-37.0	28AF32	30±1	±1.00	1.25	1.40
WR62	15.5-17.5	62AF12	20±1	±0.50	1.15	0.60
	15.5-17.5	62AF22	30±1	±0.50	1.15	0.75
	15.5-17.5	62AF32	40±1	±1.00	1.15	0.95
WR75	10.0-15.0	75AF12	10±1	±1.00	1.50	0.75
WR90	8.5-10.5	90AF12	20±1	±0.50	1.20	1.05
	8.5-10.5	90AF22	30±1	±0.50	1.20	1.40
	8.5-10.5	90AF32	40±1	±0.50	1.20	1.75
	8.5-10.5	90AF42	50±1	±1.00	1.20	2.05

Attenuator with Pad in Waveguide

W/G SIZE	FREQ. RANGE (GHz)	MDL MODEL NUMBER	ATTENUATION dB (NOMINAL)	SENSITIVITY dB (MAX.)	VSWR (MAX.)	ATTENUATOR PAD "B" (+0.20)
WR28	31.0-37.0	28AF16	10±1	±0.50	1.20	0.70
	31.0-37.0	28AF26	20±1	±1.00	1.25	1.11
	31.0-37.0	28AF36	30±1	±1.00	1.25	1.60
WR62	15.5-17.5	62AF16	20±1	±0.50	1.15	1.00
	15.5-17.5	62AF26	30±1	±0.50	1.15	1.15
	15.5-17.5	62AF36	40±1	±1.00	1.15	1.35
WR75	10.0-15.0	75AF16	10±1	±1.00	1.50	1.15
WR90	8.5-10.5	90AF16	20±1	±0.50	1.20	1.45
	8.5-10.5	90AF26	30±1	±0.50	1.20	1.80
	8.5-10.5	90AF36	40±1	±0.50	1.20	2.15
	8.5-10.5	90AF46	50±1	±1.00	1.20	2.45